



# Mike Wells

## Property Appraiser

Proudly Serving Pasco County, Florida

DADE CITY  
East Pasco Government Center  
14236 6th St. Ste. 101  
Dade City, FL 33523-3411  
(352) 521-4433 Main No.  
(352) 521-4411 Fax No.

LAND O' LAKES  
Central Pasco Professional Center  
4111 Land O' Lakes Blvd., Ste. 106  
Land O' Lakes, FL 34639-4437  
(813) 929-2780 Main No.  
(813) 929-2784 Fax No.

NEW PORT RICHEY  
West Pasco Government Center  
8731 Citizens Drive, Suite 130  
New Port Richey, FL 34654-5572  
(727) 847-8161 Main No.  
(727) 847-8013 Fax No.

Internet Address: [www.pascopa.com](http://www.pascopa.com)

Map date: October 04, 2023  
Photo date: January 2023  
Source: SWFWMD  
Proj/Datum: SP/HARN

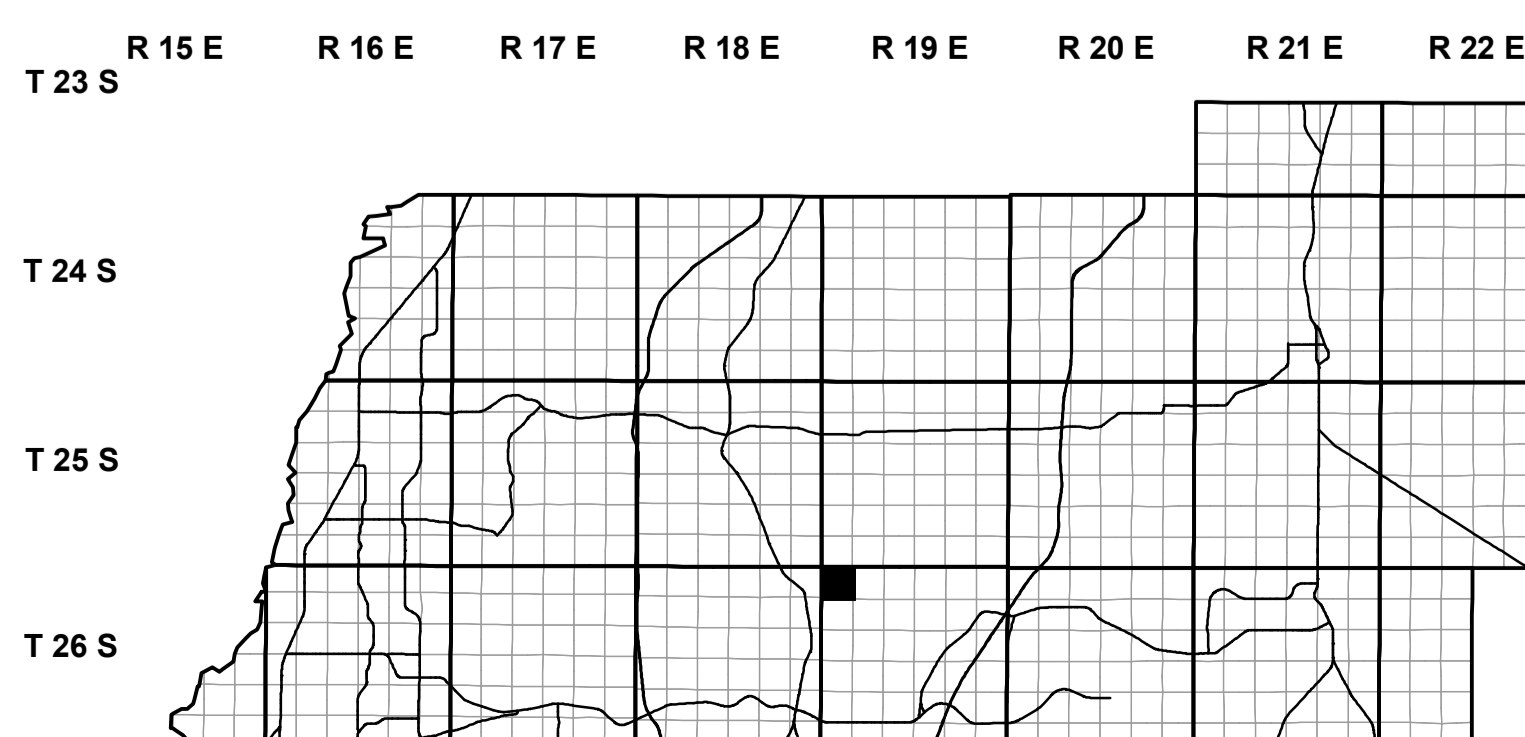

This map is the product of the Pasco County Property Appraiser's Office. This map was produced for assessment purposes only. There are no warranties made as to the fitness of this map for any unlisted purpose or reproduction other than the original scale.

1 inch = 222 feet



SECTION	TOWNSHIP	RANGE
<b>06</b>	<b>26</b>	<b>19</b>