

Mike Wells

Property Appraiser

Proudly Serving Pasco County, Florida

DADE CITY
 East Pasco Government Center
 14236 6th St. Ste. 101
 Dade City, FL 33523-3411
 (352) 521-4433 Main No.
 (352) 521-4411 Fax No.

LAND O' LAKES
 Central Pasco Professional Center
 4111 Land O' Lakes Blvd., Ste. 106
 Land O' Lakes, FL 34639-4437
 (813) 929-2780 Main No.
 (813) 929-2784 Fax No.

NEW PORT RICHEY
 West Pasco Government Center
 8731 Citizens Drive, Suite 130
 New Port Richey, FL 34654-5572
 (727) 847-8161 Main No.
 (727) 847-8013 Fax No.

Internet Address: www.pascopa.com

Map date: December 21, 2023
 Photo date: January 2023
 Source: SWFWMD
 Proj/Datum: SP/HARN

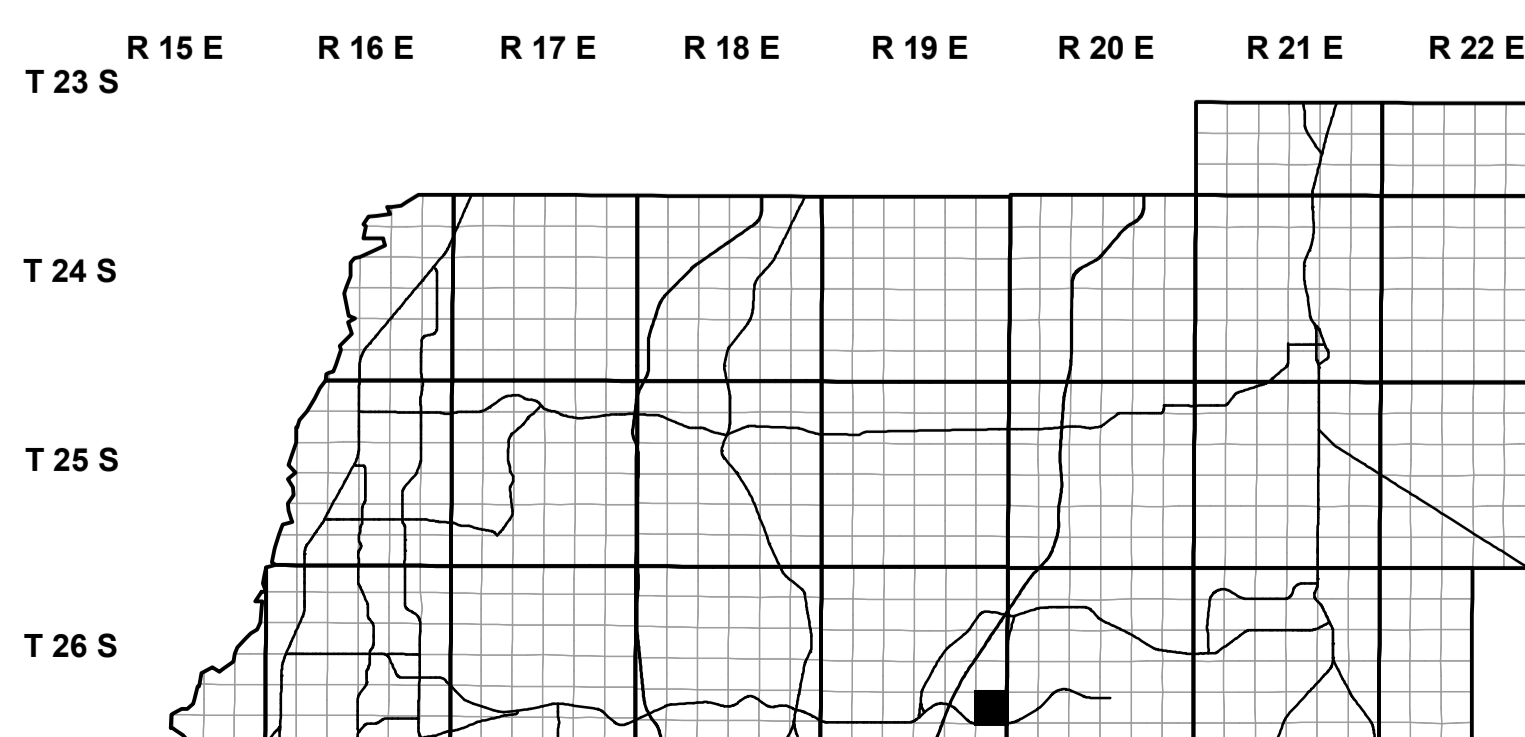

This map is the product of the Pasco County Property Appraiser's Office. This map was produced for assessment purposes only. There are no warranties made as to the fitness of this map for any unlisted purpose or reproduction other than the original scale.

1 inch = 214 feet



SECTION	TOWNSHIP	RANGE
25	26	19