

Mike Wells

Property Appraiser

Proudly Serving Pasco County, Florida

DADE CITY
East Pasco Government Center
14236 6th St. Ste. 101
Dade City, FL 33523-3411
(352) 521-4433 Main No.
(352) 521-4411 Fax No.

LAND O' LAKES
Central Pasco Professional Center
4111 Land O' Lakes Blvd., Ste. 106
Land O' Lakes, FL 34639-4437
(813) 929-2780 Main No.
(813) 929-2784 Fax No.

NEW PORT RICHEY
West Pasco Government Center
8731 Citizens Drive, Suite 130
New Port Richey, FL 34654-5572
(727) 847-8161 Main No.
(727) 847-8013 Fax No.

Internet Address: www.pascopa.com

Map date: June 22, 2023
Photo date: January 2020
Source: SWFWMD
Proj/Datum: SP/HARN

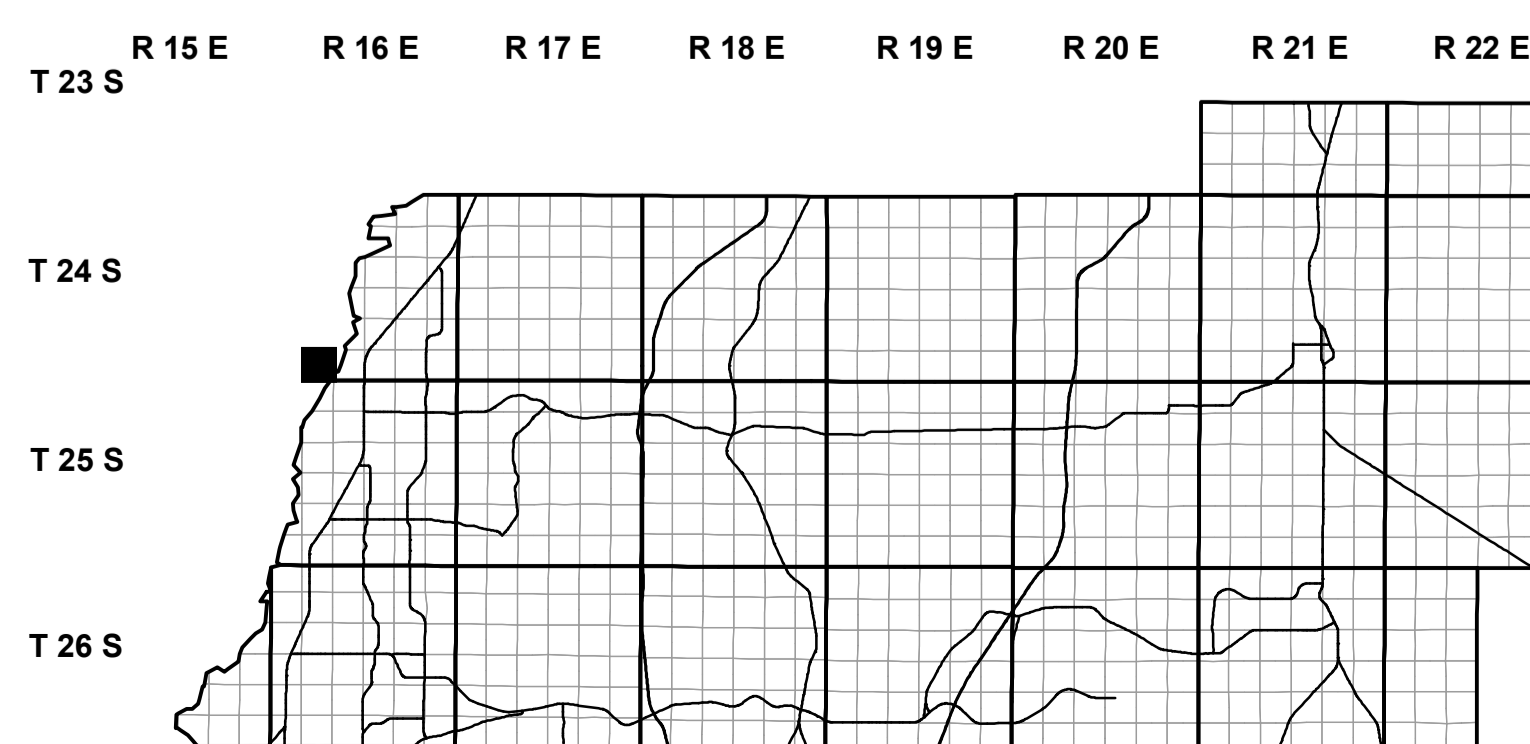

This map is the product of the Pasco County Property Appraiser's Office. This map was produced for assessment purposes only. There are no warranties made as to the fitness of this map for any unlisted purpose or reproduction other than the original scale.

1 inch = 217 feet

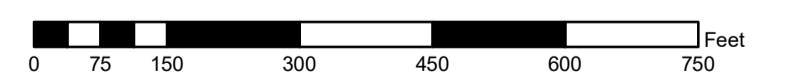

SECTION	TOWNSHIP	RANGE
32	24	16