



**Mike Wells**  
**Property Appraiser**  
 Proudly Serving Pasco County, Florida

DADE CITY  
 East Pasco Government Center  
 14236 6th St., Ste. 101  
 Dade City, FL 33523-3411  
 (352) 521-4433 Main No.  
 (352) 521-4411 Fax No.

LAND O' LAKES  
 Central Pasco Professional Center  
 4111 Land O' Lakes Blvd., Ste. 106  
 Land O' Lakes, FL 34639-4437  
 (813) 929-2780 Main No.  
 (813) 929-2784 Fax No.

NEW PORT RICHEY  
 West Pasco Government Center  
 8731 Citizens Drive, Suite 130  
 New Port Richey, FL 34654-5572  
 (727) 847-8161 Main No.  
 (727) 847-8013 Fax No.

Map date: March 27, 2024  
 Photo date: January 2023  
 Source: SWFWMD  
 Proj/Datum: SP/HARN

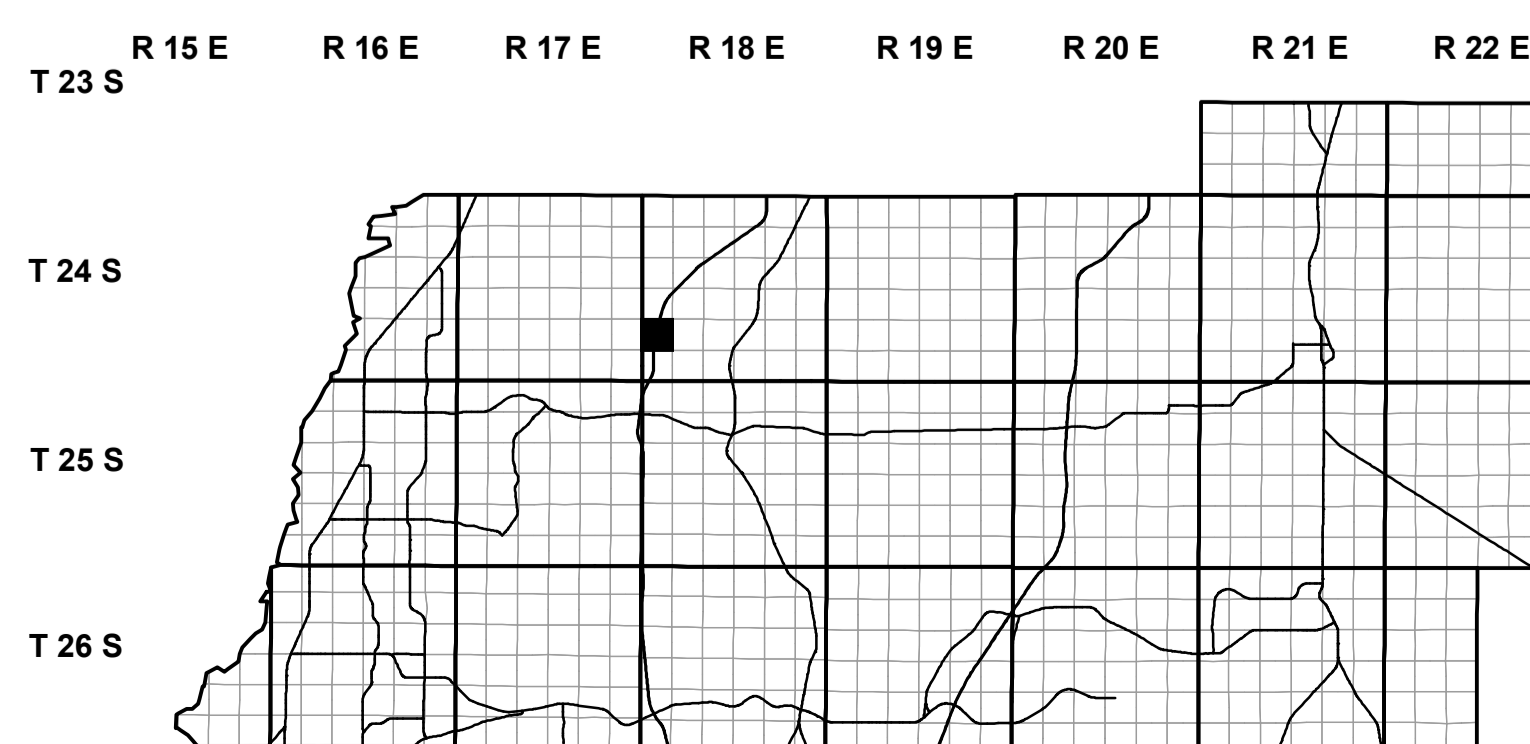

This map is the product of the Pasco County Property Appraiser's Office. This map was produced for assessment purposes only. There are no warranties made as to the fitness of this map for any unlisted purpose or reproduction other than the original scale.

1 inch = 209 feet  
 0 70 140 280 420 560 700 Feet

SECTION	TOWNSHIP	RANGE
<b>30</b>	<b>24</b>	<b>18</b>